

Range hood

DI-RG

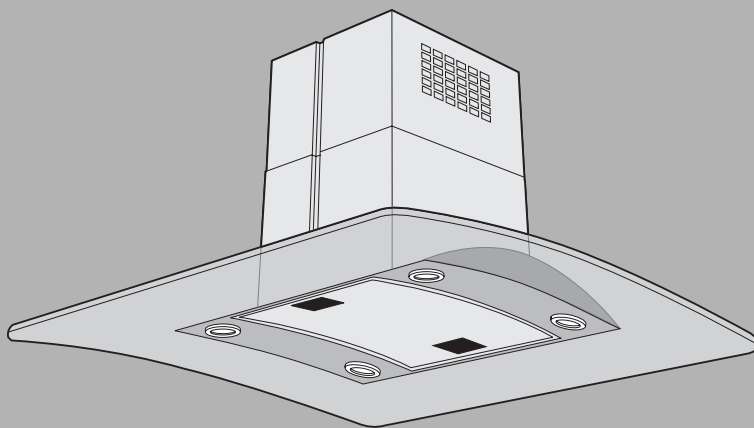

Operating instructions

Dear V-ZUG Customer

Thank you for choosing to buy one of our products.

Your appliance is made to high standards and is easy to use. Nevertheless, please take the time to read these operating instructions in order to familiarize yourself with the appliance and get the best use out of it.

Please follow the safety precautions.

Modifications

Text, diagrams and data correspond to the technical standard of the appliance at the time these operating instructions went to press. The right to make technical modifications for the purpose of the further development of the appliance is reserved.

Symbols used



Denotes important safety precautions. Failure to observe said precautions can result in injury or damage to the appliance or fittings!

- ▶ Indicates step-by-step instructions.
 - Describes how the appliance reacts to the steps taken.
- Indicates a list.



Denotes useful tips for the user.

Validity

The model number corresponds to the first three digits on the identification plate. These operating instructions apply to the model:

Type	Model no.
DI-RG	872

Variations depending on the model are noted in the text.

Contents

Safety precautions	5
Before using for the first time	5
Correct use	6
Children in the home	6
Note on use	7
Appliance description	9
Extraction model	9
Recirculation model	9
Fitted with	10
Construction	10
Operating and display elements	11
Operating the appliance	12
Operation	12
Intensive level	13
Illumination	13
Care and maintenance	15
Cleaning the housing	15
Cleaning the grease filter	16
Changing the standard activated charcoal filter	18
Replacing the halogen light	19
Trouble-shooting	20
What to do if	20

Accessories and spare parts	21
Technical data	22
Disposal	23
Notes	24
Index	25
Repair service	27
Quick instructions	28

Safety precautions



The appliance corresponds to recognised technology standards and the relevant safety regulations. Proper use of the appliance is however essential to avoid damage and accidents. Please therefore follow the precautions given in these operating instructions.

In accordance with the requirements of IEC 60335-1:

- This appliance is not intended for use by persons (including children) with reduced physical, sensory or mental capabilities, or lack of experience and knowledge, unless supervised or unless they have been given instruction concerning the use of the appliance by a person responsible for their safety.

Before using for the first time

- The appliance must be installed and connected up to the electricity supply according to the separate installation instructions. The necessary work should be carried out by a qualified fitter or electrician.
- Dispose of the packaging material in accordance with local regulations.

Correct use

- The appliance is designed for use in the home for extracting cooking fumes and smells from above the cooking surface.
- Any repairs, modifications or manipulations to the appliance, especially any electrically live parts, should only be carried out by the manufacturer, its Customer Services or similarly qualified persons. Repairs if carried out incorrectly may cause serious injury, damage to the appliance and fittings, as well as affect the functioning of the appliance. If the appliance is not working properly or in case of a repair order, follow the instructions given in the 'Repair service' section. Please contact our Customer Services if necessary.
- Use original spare parts only.
- Retain these operating instructions for future reference. If you sell or pass the appliance on to a third party, please ensure these operating instructions, together with the installation instructions, accompany the appliance. In this way, the new owner can inform themselves about how to use the appliance correctly and read the pertinent safety precautions.

Children in the home

- Packaging material (e. g. plastic, polystyrene) can be dangerous for children. Danger of suffocation! Please keep packaging material away from children.
- The appliance is designed for use by adults who are familiar with these operating instructions. Children are often unable to recognise the danger of electrical appliances. Ensure proper supervision and do not allow children to play with the appliance – there is a danger that children can hurt themselves.

Note on use

- If the appliance is visibly damaged, do not use it. Contact our Customer Services.
- If the appliance is not operating properly, disconnect it from the electricity supply immediately.
- Do not flambé food underneath the hood as the grease filters if laden with grease could catch fire.
- If frying on the cooking surface, do not leave the frying appliance unattended. The cooking oil in the frying appliance could overheat and catch fire. Constantly monitor the temperature of the cooking oil, keeping it below the temperature at which it can catch fire. Change the cooking oil regularly – dirty oil catches fire more easily than clean oil.
- Clean the filters regularly. Failure to do so can increase the fire hazard due to the build-up of grease in the grease filter.
- Do not operate the individual cooking zones of the cooking surface without a pan on them or with an empty pan on them so as to avoid damaging the appliance or the kitchen fittings through a build-up of heat. Avoid open fires with oil, gas, wood and coal fired cookers.
- Ensure there is adequate ventilation when the extraction fan is on so as to avoid creating a disturbing underpressure in the kitchen and to achieve optimal air extraction.

- If another appliance – fuelled by gas or other fuels – is being used at the same time, ensure that there is a sufficient supply of fresh air. This does not apply to air recirculation units.
- With the simultaneous operation of chimney-dependent firing (e. g. Swedish oven, gas, oil or coal-fired heaters, continuous flow heaters or water heaters) safe operation is only possible providing a room negative pressure of 4 Pa (0.04 mbar) is not exceeded at the location of the appliance. Risk of toxic fumes! An adequate flow of fresh air must be guaranteed, e. g. via non-closable openings in doors and windows and combined with ventilation wall bricks for incoming and exhaust air or by other technical means.
- When carrying out maintenance work on the appliance, including replacing the light bulb, cut off the electricity supply to the appliance (remove the screw fuse from the holder or switch the circuit breaker off, or disconnect from the mains supply).
- When cleaning the appliance make sure no water gets inside the appliance. Use a moderately damp cloth. Do not spray the inside or outside of the appliance with water. Do not use a steam cleaner. If water gets inside the appliance, it can cause damage.

Appliance description

The appliance is designed to extract cooking fumes and smells from the cooking area. This particular model can be used to extract or to recirculate air.

Extraction model

The cooking fumes are extracted by a ventilator. The metal grease filters clean the extracted air, which is passed through a connecting pipe fitted with an integrated non-return valve and through the air duct to the outside.



When the appliance is in use, ensure there is a sufficient supply of fresh air to replace the air that is being extracted.

Recirculation model

The cooking fumes and smells above the cooking area after being filtered through the metal grease filter are passed through an activated charcoal filter. The filtered air is then circulated back into the room through the side openings.



If activated charcoal filters are not supplied with the appliance, these should be ordered and installed before using the appliance. Furthermore, the saturation indicator for the activated charcoal filters must also be activated.

Fitted with

- 1 extraction fan
- Illumination
- 1 metal grease filter
- 1 activated charcoal filter (not included in scope of delivery)

The extraction fan has 4 power levels.

- 1 = low, 2 = medium, 3 = high and intensive level.
- Power levels 1–3 can be used for longer periods of operation.
- The intensive level is for shorter bursts of intensive extraction of the cooking fumes and smells, e.g. when searing meat. The intensive level runs for a maximum of 5 minutes at a time.

Construction

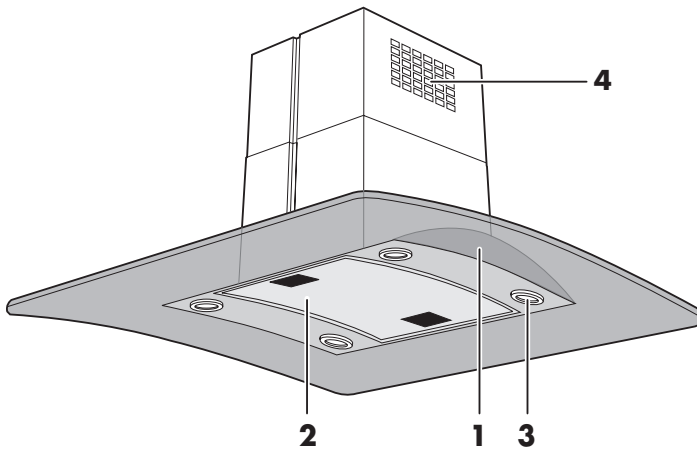

- 1** Operating panel
- 2** Metal grease filter
- 3** Halogen light
- 4** Return air in recirculation model

Operating and display elements

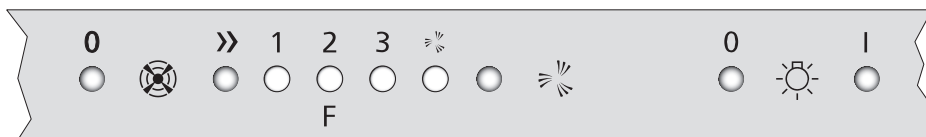

Buttons

Operation 

- »** Switch on / Power level
- 0** Switch off / Reset saturation indicator

Intensive level 
Intensive level

Illumination 

- I** On
- 0** Off

Indicator lights

- 1** Power level 1
- 2 / F** Power level 2 / Saturation indicator for metal grease filter
- 3** Power level 3 / Saturation indicator for standard activated charcoal filter
-  Intensive level



Depending on the model and features, the specification of the appliance may differ from the standard specification described herein.

Operating the appliance

Operation

Switching the appliance on / Selecting the power level

- ▶ Pressing the >> button switches the appliance on at power level 1.
 - The indicator light **1** comes on.
- ▶ To select power levels 2 or 3, repeatedly press the >> button.
 - The indicator light shows which power level is currently being used.



We recommend switching the appliance on at power level 1 some 5 minutes before cooking. Use a low power level for normal cooking smells and a higher power level for very strong cooking fumes and smells.

Switching the appliance off





- ▶ Press the **0** button to switch the appliance off.



After you have finished cooking, allow the appliance to run for another 15 minutes so that the cooking fumes and smells can be extracted.

Intensive level

The intensive level can be selected irrespective of whether the appliance is switched on or off.

- ▶ Press the  button to switch the intensive level on for 5 minutes.
 - The indicator light  lights up.
 - If a different power level had been running beforehand, then the appliance will automatically revert to this after the 5 minutes has elapsed.
 - If the appliance had been switched on beforehand, then the appliance will automatically switch off after the 5 minutes has elapsed.
- ▶ Press the  or  button to stop the intensive level before the 5 minutes is up.

Illumination

- ▶ Press the **I** button to switch the illumination on.
- ▶ Press the **0** button to switch the illumination off.



The illumination can be used on its own.

Saturation indicator for the metal grease filter

The indicator light **2 / F** flashes after 40 operating hours. The saturation level is reached and the grease filter must be cleaned.

Saturation indicator for the standard activated charcoal filter

The indicator light **3** flashes after 160 operating hours. The saturation level is reached and the standard activated charcoal filter must be replaced.



The saturation indicator is deactivated at the factory. If the appliance is being used as a recirculation model, the saturation indicator must first be activated.

To activate the saturation indicator

- ▶ Depress the **>>** and  buttons at the same time for 3 seconds.
 - The indicator light **2 / F** flashes.
 - After 3 seconds the indicator light **3** flashes. The saturation indicator is activated.

To deactivate the saturation indicator

- ▶ Depress the **>>** and  buttons at the same time again.
 - After 3 seconds the indicator light **3** goes out. The saturation indicator is deactivated.

Care and maintenance

Cleaning the housing



Take care that no water gets into the housing of the appliance! If water gets into the housing, it can cause damage.



Do not use abrasive cleaners, scouring pads, steel wool, etc., as they can damage the surface.

Cleaning the outside / inside

- ▶ Clean the outside using a slightly damp cloth – and detergent if necessary – and wipe dry.

Grease and condensate water can build up on the inside next to the grease filters.

- ▶ Clean using a slightly damp cloth – and detergent if necessary – and wipe dry.

Cleaning the grease filter

The grease filter must be cleaned at least once a month with normal use or whenever the indicator light **2 / F** flashes. If properly cared for, the grease filter should provide unlimited years of service.

- ▶ Clean the grease filter in the dishwasher.
- ▶ Select an «intensive» – or «heavy» – wash programme with a warm pre-wash.



Cleaning may cause the grease filter to become discoloured. However, this will not affect the functioning of the filter in any way.

If you do not have a dishwasher:

- ▶ Clean the grease filter in the sink with hot water and detergent.
- ▶ Then soak the filter in hot water in the sink for about 2 hours and finally clean with a washing-up brush.

Removing the grease filter

- ▶ Push both grips **1** inwards.
- ▶ Carefully pull the grease filter down and out of fixture.



Take care not to damage the grease filter.

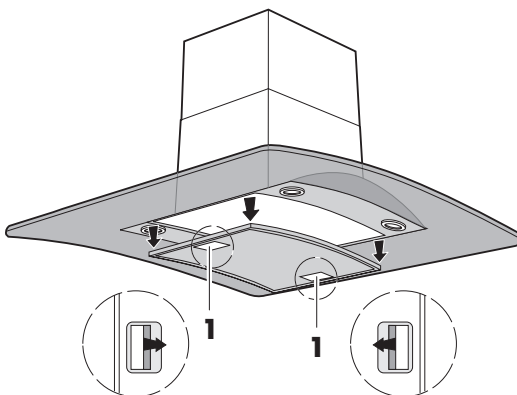

Replacing the grease filter

- ▶ Push both grips **1** inwards.
- ▶ Insert the grease filter into fixture and engage in position.
- ▶ Hold the **0** button depressed for at least 3 seconds.
 - An acoustic signal is emitted.
 - The **2 / F** indicator light goes out.

Changing the standard activated charcoal filter

Standard activated charcoal filters are only used in the recirculation model.

Standard activated charcoal filters become less effective with use. With normal use, they have to be changed at least every 4 months or whenever the indicator light **3** flashes. They cannot be washed or regenerated.



The standard activated charcoal filter can be disposed of in the household waste.

- ▶ Disconnect the appliance from the mains supply (remove the fuse, switch the circuit breaker off or pull the plug out of the mains socket).
- ▶ Remove and clean the grease filters.
- ▶ Remove both screws **A**.
- ▶ Remove the standard activated charcoal filter from below and change it.
- ▶ Insert the new standard activated charcoal filter.
- ▶ Replace both screws.
 - The filter is fixed in.
- ▶ Replace the metal grease filter.
- ▶ Replace the fuse, switch the circuit breaker back on again and plug the appliance back into the mains supply.
- ▶ Depress the **0** button for at least 3 seconds.
 - An acoustic signal is emitted.
 - The indicator light **3** goes out.

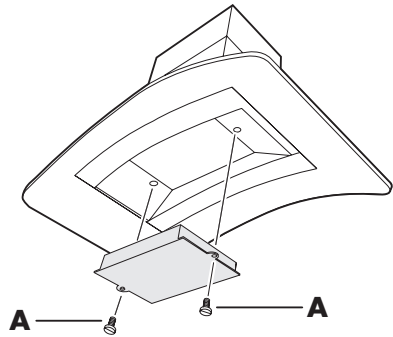

Replacing the halogen light



Remove screw fuse or switch off circuit breaker.

Halogen lights get hot during operation! Allow to cool down first.

- ▶ Unscrew the ring with the integrated glass.
- ▶ Replace the defective halogen light with a bulb of the same type (max. 20 watts).



Avoid touching the halogen light with bare hands. Use a soft, dry and grease-free cloth.

- ▶ Clean the ring and the glass.
- ▶ Screw the ring back in place.
- ▶ Put the screw fuse back in or switch the circuit breaker back on again.

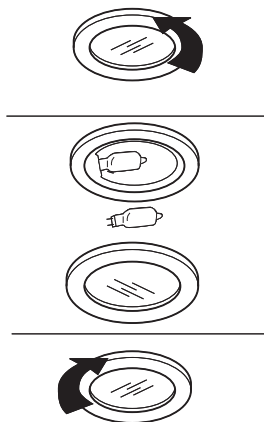

Trouble-shooting

What to do if ...

... the illumination is not working

Possible cause	Solution
■ Fuse or circuit breaker for electrical installations in the home is faulty.	▶ Change the fuse. ▶ Reset the circuit breaker.
■ Interruption in the power supply.	▶ Check the power supply.
■ The halogen light is faulty.	▶ Change the halogen light.

... the appliance is not extracting enough air

Possible cause	Solution
■ Grease filter is dirty.	▶ Clean grease filter.
■ The activated charcoal filter (in the recirculation model) is spent.	▶ Change the activated charcoal filter.

Accessories and spare parts

Please give model number and exact description when ordering parts.

Halogen light

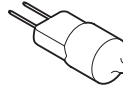

Metal grease filter

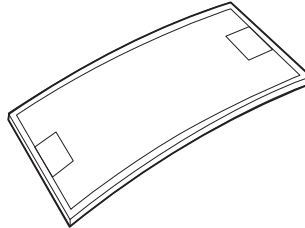

Activated charcoal filter

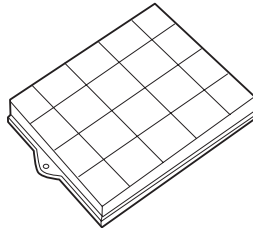

The halogen light is also available from specialist retailers.

Technical data

Voltage / Frequency

230 V~ 50 Hz

Power consumption

■ Extractor fan

160 W

■ Illumination

4 × 12 V / 20 W

Total connected load

240 W

Connection via mains cable with plug

Length 1.2 m

Disposal

Packaging

- All packaging materials (cardboard, plastic film (PE) and polystyrene (EPS)) are marked and should, if possible, be collected for recycling and disposed of in an environmentally friendly way.

Disconnection

- Disconnect the appliance from the mains. With a fixed appliance, this is to be carried out by a qualified electrician!

Safety

- Disable the appliance to prevent accidents caused by improper use, especially through children playing.
- Pull the plug out of the mains socket or have the appliance disconnected from the mains by a qualified electrician. Then cut off the mains cable.

Disposal

- The old appliance should not be discarded as worthless rubbish. If disposed of correctly, the raw materials can be recovered for recycling.



- The  symbol on the identification plate warns that the appliance may not be disposed of in normal household waste.
- The appliance must be disposed of in accordance with local regulations on waste disposal.

For more information on the handling, disposal and recycling of the product, please contact the local authorities, the local recycling facilities for household waste or the retailer from whom you purchased the appliance.

Notes

Index

A

- Accessories 21
- Activated charcoal filter 9, 18
 - Saturation indicator 14
 - Standard 14, 18

C

- Care 15
- Children in the home 6
- Cleaning 15
- Construction 10

D

- Disconnection 23
- Display elements 11
- Disposal 23

E

- Extraction model 9

F

- Features 10

G

- Grease filter
 - Activated charcoal filter 18
 - Cleaning 16
 - Metal grease filter 10
 - Saturation indicator 11, 14

H

- Halogen light 10, 19

I

- Illumination 13
- Intensive level 13

M

- Maintenance 15
- Metal grease filter 10
 - Saturation indicator 14

O

- Operating elements 11
- Operating panel 10

P

- Packaging 23
- Power level selection 12

Q

- Quick instructions 28

R

- Recirculation model 9
- Repair service 27
- Return air 10

S

Safety 23

Safety precautions

- Before using for the first time 5
- Children in the home 6
- Correct use 6
- Note on use 7

Saturation indicator 11, 14

Spare parts 21

Standard activated charcoal filter . 18

- Saturation indicator 14

Switching off 12

Switching on 12

Symbols 2

T

Technical data 22

Trouble-shooting 20

U

Using for the first time 5

Repair service



The 'Trouble-shooting' section will help you to carry out small repairs yourself, saving you the time and trouble of calling out a service engineer and the cost that goes along with it.

Whether you contact us for repairs or orders, please always state the serial number (FN) and the name of the appliance. Enter these details below and also on the service sticker which comes with the appliance. Stick it in a conspicuous place or in your telephone or address book.

SN

Appliance

You will also find the same details on the certificate of guarantee, the original sales invoice and the identification plate of the appliance.

- ▶ Remove metal grease filter.
 - The identification plate is located on the inside of the appliance.

Quick instructions

Please first read the safety precautions in these operating instructions!

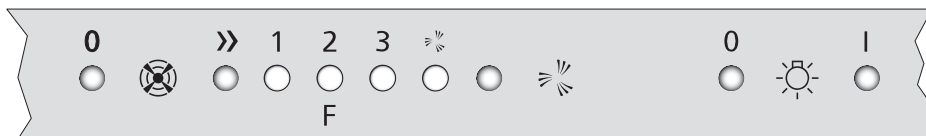

Operation

- >>** Switch on / Power level
- 0** Switch off / Reset saturation indicator

Intensive level

Intensive level

Illumination

- I** On
- 0** Off

V-ZUG Ltd

Industriestrasse 66, CH-6301 Zug
vzug@vzug.ch, www.vzug.com

J872.352-0